



Technical Specification

Product fiche

Trademark	Technika	
Model ID	32A23B-HD	40A23B-FHD
Energy efficiency class	A+	
Visible screen size (diagonal)	32" / 81cm	40" / 102cm
On-mode power consumption	31.0W	45.0W
Annual energy consumption *1	45 kWh	66 kWh
Standby power consumption *2	<0.50W	
Off mode power consumption	N/A	
Screen resolution	1366 (H) x 768 (V)	1920 (H) x 1080 (V)

*1: Energy consumption XYZ kWh per year, based on the power consumption of the television operating 4 hours per day for 365 days. The actual energy consumption will depend on how the television is used.
*2: When the TV is turned off with the remote control/standby button and no function is active.

	32A23B-HD	40A23B-FHD
RF	75 ohm Antenna / Analog / DVB / Satellite	
Inputs	3 x HDMI, 2 x USB, 1 x RJ45 LAN/Ethernet, 1x CVBS/Video input, 1x Mini Component/YpbPr input, 1 x L/R Audio input for Composite/CVBS & Component YPbPr	
Sound Outputs	1 x Digital Optical Audio output, 1 x 3.5mm Headphone	
Speaker*/ Amplifier Watts (RMS)	2 x 10 / 2 x 8	
Voltage and power consumption	AC 220V ~ 240V; 50Hz 31/45/70W (home mode/standard/max) (0.5W in Standby)	AC 220V ~ 240V; 50Hz 45/65/80W (home mode/standard/max) (0.5W in Standby)
Dimensions including stand (mm)	739W x 488H x 160D	906W x 551H x 198D
Net weight (Kgs)	4.8	6.8
Wall Mounting	VESA 200 x 100 (mm)	VESA 200 x 200 (mm)

*Built in JBL Speaker system (full-range speaker and tweeter)

SOUND SYSTEM BY



Enjoy a world class audio experience with JBL sound system built in

HDMI

The terms HDMI, HDMI High-Definition Multimedia Interface, and the HDMI Logo are trademarks or registered trademarks of HDMI Licensing Administrator, Inc.

androidtv

Google, Google Play, YouTube, Android TV and other marks are trademarks of Google LLC.

Dolby Audio

Manufactured under license from Dolby Laboratories. Dolby, Dolby Audio, and the double-D symbol are trademarks of Dolby Laboratories Licensing Corporation.



Exclusively for **TESCO**

androidtv

Quick Start Set Up Guide

For information on using the TV's features, please refer to the Operating Instructions. (Available online to download.)

Model Numbers

32A23B-HD **40A23B-FHD**

Quick & easy guide for setting up your TV

What is included in the box

Using the remote control

Setting up the TV for the first time - including attaching the stand

Connecting other devices to the Television

Need help setting up or using your TV?

Please contact the UK & ROI Helpline*

Telephone UK: 0330 024 0804 or ROI 01443 3940

Online support at: www.umc-uk.co.uk

Email support at: service@umc-uk.co.uk

*Calls to 0330 numbers are charged at standard call rates and are included as part of any bundled minutes with your phone provider.

Calls to the ROI number are charged at the local call rate.

The telephone opening hours are:

Monday to Friday: 8.30am - 6pm.
Saturday: 9am - 5pm.
Bank Holidays: 10am - 4pm.

Closed Christmas and New Years day



Sky Remote Code



If you wish to use your Sky remote to operate the TV's basic functions, you will need a Sky remote control (Revision 9 or later) and you will need to program it with the code 2134. If you wish to use your Sky Q remote to operate the TV's basic functions, you will need to program it with the code 4170.



- 1** **STANDBY** - Switch on the TV when in standby or vice versa. By long pressing of this button, the set will display a menu offering power down option to energy saving standby mode.
- 2** **SOURCE** - To display the input/source menu.
- 3** **NUMBER BUTTONS** - 0-9 to select a TV channel directly.
- 4** **MUTE** - Mute the sound or vice versa.
- 5** **TV GUIDE** - Opens the 7 day TV guide (digital TV mode).
- 6** **VOL (+/-)** - To increase/decrease the sound level.
- 7** **The Google Assistant** - Use your voice to access entertainment, control smart devices, obtain answers on screen, and more.
- 8** **HOME** - Display the TV Home Menu.
- 9** **CH (+/-)** - To increase or decrease the channel being watched.
- 10** **MENU** - Display LIVE TV menu. This button works only in sources (TV, HDMI, Component, etc.). It will not work in the Home Menu.
- 11** **INFO** - Press once for now/next channel information.
- 12** **(+/-/+/+)** - Allows you to navigate the on-screen menus and adjust the system settings to your preference.
- 13** **BACK** - To go back a previous step.
- 14** **EXIT** - To exit all menus.
- 15** **NETFLIX** - Access the Netflix App.
- 16** **Prime video** - Access the Prime video App.
- 17** **YouTube** - Access the YouTube App.
- 18** **Freeview Play** - Access the Freeview Play app.
- 19** **MTS** - Opens audio track menu.
- 20** **TEXT** - To enter/exit text.
- 21** **SUB** - To switch the dialogue at the bottom of the screen (on/off).
- 22** **TV** - To switch to Live TV.
- 23** **PAUSE** - To play/pause media.
- 24** **REWIND** - To play in fast rewind mode.
- 25** **PLAY** - To stop the playback.
- 26** **STOP** - To stop the playback.
- 27** **COLOUR BUTTONS** - Execute corresponding function at that time.

Please save your box/packaging as you will need this in the event of warranty/service repair or support. We are unable to carry out warranty/service if you are unable to package it correctly. The safest way to package your item in the event of warranty/service repair is in its original box/packaging.

Freeview Play brings together live TV viewing with "catch up" TV services such as BBC iPlayer, More4 and Demand 5. The Freeview Play Explore app features a carousel of genres to select from when searching for programmes, such as sport, comedy, dramas and soaps, etc. Content is made up from recommendations of the major broadcasters and offers an alternative means of searching.

Note that to use the full functionality of Freeview Play your set must be connected to the internet.

This product contains technology subject to certain intellectual property rights of Microsoft. Use or distribution of this technology outside of this product is prohibited without the appropriate license(s) from Microsoft.

Content owners use Microsoft PlayReady™ content access technology to protect their intellectual property, including copyrighted content. This device uses PlayReady technology to access PlayReady-protected content and/or WMDRM-protected content. If the device fails to properly enforce restrictions on content usage, content owners may require Microsoft to revoke the device's ability to consume PlayReady-protected content. Revocation should not affect unprotected content or content protected by other content access technologies. Content owners may require you to upgrade PlayReady to access their content. If you decline an upgrade, you will not be able to access content that requires the upgrade.

- Accessories included with this TV are the following accessories
- 1 x Quick Start Guide
 - 1 x Remote Control and 2 x AAA Batteries
 - 1 x Safety Leaflet
 - 1 x RF Cable
 - 1 x Mini YPbPr Cable
 - Required if you wish to connect a device with YPbPr Component output to the TV's Mini YPbPr input
 - 4 x Screws
 - 1 x Stand installation pack
 - 1 x L (left)
 - 1 x R (right)

What is included in the box

To launch the online manual, press the HOME button, select Apps from the Home menu, and select "E-Instruction Manual" from the apps list.

Online Manual

Using the remote control

Setting up the TV set for the first time

To obtain a copy of your Operating Instructions, please go to: www.umc-uk.co.uk/Manuals/Technika.php

1 Fitting the stand

Follow steps 1 - 3 to safely install the TV stand

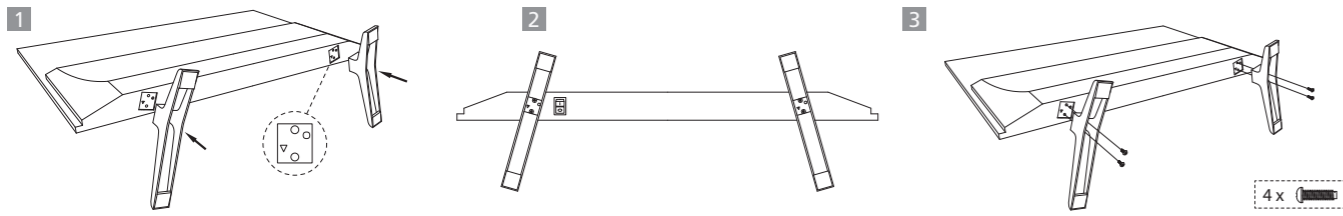

Place the TV set on a flat and clean surface with the panel facing downwards to avoid damage.

When fitting the feet, the longest part of the foot needs to be at the front of the set. In addition these should be pointing away from each other as shown in the picture above.

When the stand feet are in the correct position, secure the stand feet to the TV set using the 4 screws provided.

2 Installing batteries

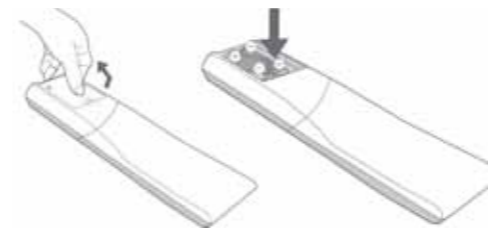

Remove the battery cover from the rear of the remote control and insert the AAA batteries which are supplied in the accessory pack. Ensure that the polarity of the batteries is as shown in the battery compartment. Replace the battery cover. The remote control is ready for use.

3 Connecting your set



- 1 Connect the TV to your power socket.
- 2 If you wish to use the TV to receive Freeview/Saorview channels, connect the RF input from the TV to your outdoor Digital TV aerial. If you do not wish to receive Freeview/Saorview, skip this step.
- 3 Connect to the internet. Ethernet provides the most stable connection.

4 Button layout

- 1 Standby Power On/Off
- 2 Displays the input source menu
- 3 Displays Menu/OSD
- 4 Programme/Channel down and menu down
- 5 Programme/Channel up and menu up
- 6 Volume down and menu left
- 7 Volume up and menu right

5 Wall Mounting the TV Optional

- 1) Remove the four screws that are supplied in the wall mounting holes.
- 2) The wall mount can now be easily attached to the mounting holes on the rear of the TV.
- 3) Install the wall mounting bracket to the television as advised by the bracket manufacturer.

Image for illustration only.

The picture shows the use of spacers, which are not applicable to all sets/installations.

For the dimensions of the VESA mounting, please refer to the Technical Specifications section of this document.

6 First time installation

Basic installation steps are shown below. These may vary slightly depending on your model. Due to Android software updates, the look and feel of the TV start up procedure and subsequent menus can be subject to change.

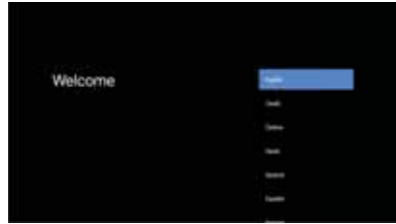

When the set first turns on, it will ask you to select your preferred on-screen display language. This will change the language in which the menus and associated information is displayed in.

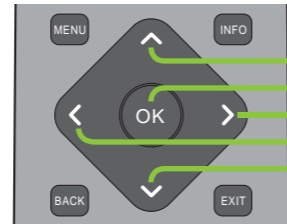

- Press to navigate up
- Press to confirm a selection
- Press to navigate right
- Press to navigate left
- Press to navigate down

Android Phone users

During the set-up process, you will be prompted to sign-in to your Google account using your pre-installed "Google" app. This set up process will depend upon which model TV you are setting up. Please ensure you have your account details to hand.

7 Pairing the remote

If during the first time installation process the remote was not paired or skipped, then follow the process below to pair your remote with the television.

- 1) Turn the set on.
- 2) Press the button on the remote control.
- 3) The LED indicator on the remote will illuminate and the pairing screen will appear on the TV.
- 4) Now press and hold the "Left" and "Home" buttons on the remote simultaneously.

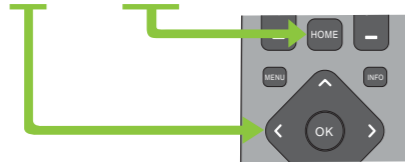

- 5) The LED indicator on the remote control will start to flash.
- 6) Select the detected remote control shown on the screen and press OK.
- 7) Once paired the pairing screen will disappear.

This process will only need to be carried out if the remote is not paired. Once paired, when the button is pressed it will open the Google Assistant screen on the set and activate voice functionality.

8 The Google Assistant



Using the Google Assistant with your voice

Remote controls with the Google Assistant have a Google Assistant dedicated button and a built-in microphone. To use this feature with the Google Assistant remote control, follow the instructions as below.

- 1) Before using the Google Assistant, you will need to pair the remote. Please follow step 5 of this guide to pair your remote to enable the Google Assistant.
- 2) Press the button. The LED indicator on the remote control will illuminate.
- 3) Wait for the on-screen message from the Google Assistant, then speak into the microphone. A good rule of thumb is to have the microphone positioned about 15-30 centimetres away from your mouth.

By speaking into the microphone, you can search for various content or control your connected smart home devices. Speech examples may be displayed on the television screen depending on your model.

Register your product online within 14 days of purchase and get 6 months extra guarantee for FREE at: www.umc-uk.co.uk/free6

Registration must be performed online

Please have your proof of purchase/receipt as well as the model/ref and serial number to hand as you will need this during registration. You can find the model/ref and serial number either on the box/packaging or on the label on the rear of the TV.

MODEL NO.
Example: 32G23-HD/DVD

SERIAL NUMBER
Between 26-33 characters long

ACT NOW!

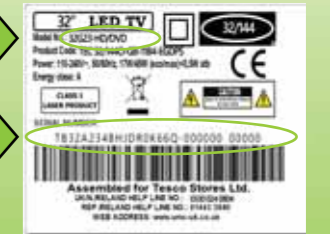

Example of label on rear of TV

The small print...

This offer is ONLY available online. Register your product at www.umc-uk.co.uk/free6 within 14 days of purchase and you will receive an extra 6 months manufacturers guarantee FREE of charge, giving you 18 months instead of the usual 12 months

Connectivity

Use this connectivity guide to identify the location of the TV's inputs and outputs.

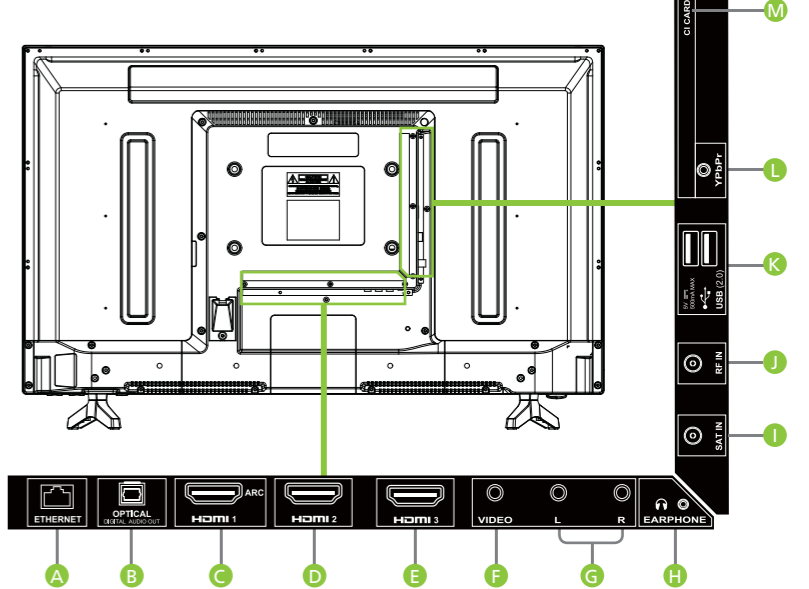

A	LAN*	Network Connection	H	Earphone	Earphones input
B	Digital audio	Digital optical audio output	I	SAT in	Satellite input
C	HDMI 1 (ARC)	HDMI input	J	RF in	RF/TV Aerial input
D	HDMI 2	HDMI input	K	USB 2.0	USB 2.0 input x2
E	HDMI 3	HDMI input	L	Mini YPbPr in	HD input (YPbPr)
F	Video	Composite/CVBS in	M	CI card in	Common interface module
G	L/R	Audio shared for Composite/CVBS and Component/YPbPr			

* The Ethernet/LAN port is used for Freeview HD services and smart functions.